

OPEN DAY 2024

FRIDAY 21 JUNE
10AM - 2PM

TAURANGA
CAMPUS
PROGRAMME
& MAP

FOR THE PEOPLE
KO TE TANGATA



THE UNIVERSITY OF
WAIKATO
Te Whare Wānanga o Waikato

At Open Day you can learn more about study options, meet our students and staff and experience Waikato student life first-hand.

Use this programme to find out what's happening during Open Day, decide what information sessions you want to attend and find your way around campus.

FUTURE STUDENTS TEAM

Prospective students, and their families and whānau, can talk to the Future Students Team about study options, get support with the enrolment process, and learn more about scholarships, accommodation, student support and other services.

Our team are available for phone, online or face-to-face appointments (in either Tauranga or Hamilton) between 9am and 4pm, Monday to Friday.

You can book appointments by phone or email.

☎ 0800 WAIKATO (0800 924 528)

✉ recruitment@waikato.ac.nz

INTRODUCING

our WaikatoUni App. Download the app today and have all the relevant information you need in the palm of your hand. Discover your study options, hear about exciting upcoming events, and get reminders about key dates.



OPEN DAY INFORMATION SESSIONS

We have a full programme of information sessions on subjects, degrees and student support. Come along to hear from our teaching staff and current students about what life is like at the University of Waikato in Tauranga.

The Open Day programme is also available in our Waikato Uni app, make sure you download it so you can create a personalised schedule for the day.

ARTS, LAW, SOCIAL SCIENCES & DESIGN

TITLE	SUBJECT	TIME	LOCATION
Sexuality at school: policy and practice in Aotearoa New Zealand	Social Policy, Gender and Sexuality Studies	10.20am	TCBD.G.04
Social Media - To Regulate or Not to Regulate, That Is the Question	Law	10.20am	TCBD.2.12
Trick of Treaty? What this Coalition Government means for us	Māori & Indigenous Studies	10.40am	TCBD.2.12
Why study Law at Waikato?	Law	11am	TCBD.2.03
Can You Negotiate with An Algorithm?	Law	11.20am	TCBD.G.04
Everything is Design, Design is Everything	Design	11.20am	TCBD.G.03
Good excuses for killing people (and other things Philosophy can do for you)	Philosophy	11.40am	TCBD.2.08
Who wants to save the world?	Human Rights	12.20pm	TCBD.2.12

BUSINESS & MANAGEMENT

TITLE	SUBJECT	TIME	LOCATION
Why study at Waikato Management School?	Business, Fintech, Management, Communication	10.40am	TCBD.2.03
Driving business success through Marketing and Strategic Management - Insights for tomorrow's business innovators	Marketing, Strategic Management	11am	TCBD.2.12
Keep goods moving: The dynamics of Supply Chain Management	Supply Chain Management	11.40am	TCBD.2.12
Can the Reserve Bank avoid causing a recession?	Accounting, Finance	12pm	TCBD.2.03

EDUCATION

TITLE	SUBJECT	TIME	LOCATION
A career to inspire our future generations - study Teaching with the School of Education	Education	11.20am	TCBD.2.12

FIGURING OUT ROOM NUMBERS?

It can be a bit tricky. Here's an example:

TCBD.2.03

TCBD = Tauranga Campus
2 = Building level
03 = Room number



Select the 'waikato' network, and BOOM you're in.

HEALTH & SPORT

TITLE	SUBJECT	TIME	LOCATION
Study Health at Waikato	Health	11am	TCBD.2.08
Study Sport and Human Performance	Health	11.20am	TCBD.2.08
Responding to the health workforce crisis	Pharmacy, Midwifery, Medicine	12pm	TCBD.2.08

STEM & NATURAL ENVIRONMENT

TITLE	SUBJECT	TIME	LOCATION
Have you heard about Environmental Psychology?	Psychology	10.20am	TCBD.2.08
Study Computing at Waikato	Computer Science, Software Engineering	10.20am	TCBD.G.03
Psychopathy: What causes it, and is trauma part of that puzzle?	Forensic Psychology	10.40am	TCBD.2.08
Study Engineering at Waikato	Engineering	10.40am	TCBD.G.04
Study Science at Waikato	Science	11am	TCBD.G.04
Tour of the Science Labs	Science	11.20am	Meet outside TCBD.G.04
Overview of Psychology at Waikato	Psychology	11.40am	TCBD.2.03
Kaupapa Māori Psychology: Why and how we apply mātauranga Māori to psychology	Psychology & Kaupapa Māori	12pm	TCBD.2.12

STUDENT ADVICE & SUPPORT

TITLE	TIME	LOCATION
Scholarships	10.20am	TCBD.2.03
Student Accommodation	10.40am	TCBD.G.03
Work-Integrated Learning	11am	TCBD.G.03
Student Support Services	11.20am	TCBD.2.03
Māori ki Waikato	11.40am	TCBD.G.04

UNISTART PROGRAMME

Did you know you could complete a University paper while still at High School through our Unistart programme? There are options to take papers online or at our Tauranga and Hamilton campuses.

Visit the Scholarships stand for more information.



THE UNIVERSITY OF
WAIKATO
Te Whare Wānanga o Waikato
TAURANGA



The University of Waikato
Private Bag 3105
Hamilton 3240
New Zealand

0800 WAIKATO
0800 924 528
info@waikato.ac.nz
waikato.ac.nz

© The University of Waikato, June 2024
#8664p

HAVEN'T REGISTERED YET?

Scan this QR code to register



Everyone that registers automatically goes in the draw to

WIN A PS5!



TAURANGA CAMPUS MAP



LOOKING FOR SOMETHING?

Head to the Information Hub on the Ātea (courtyard at the Durham Lane entrance), or ask anyone wearing an Open Day red t-shirt.

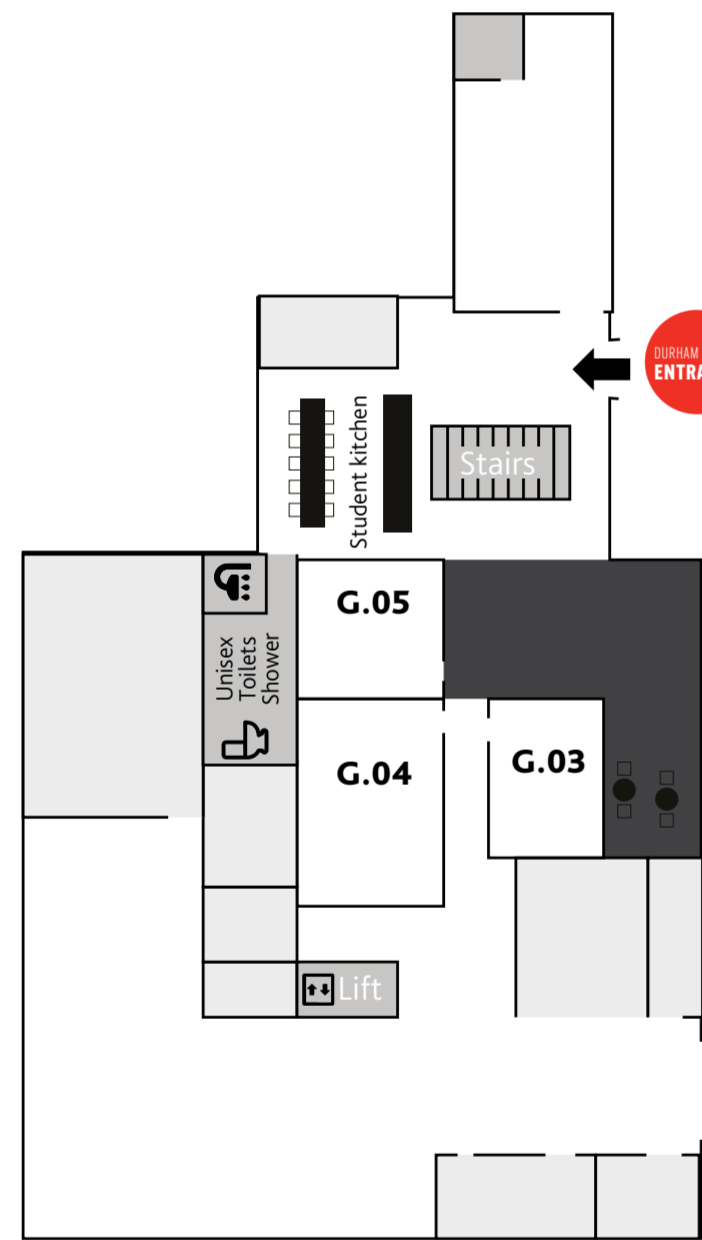

GROUND FLOOR

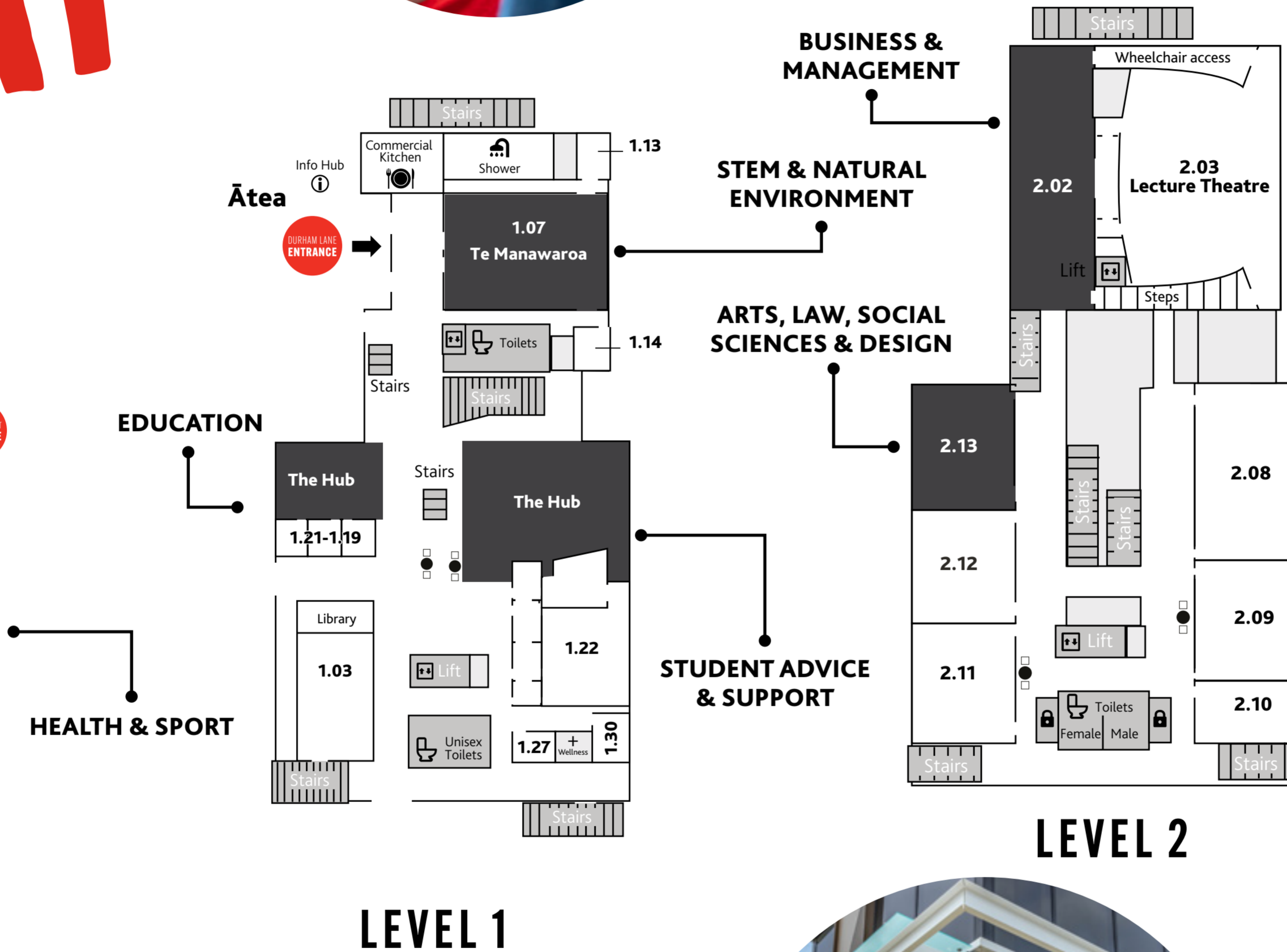

LEVEL 1

LEVEL 2

ACCOMMODATION TOURS

Take a guided tour of Selwyn Street Studios. Shuttles depart at regular intervals from Durham Lane. Talk to the Accommodation Team on level 1 for more information.



OPEN DAY ZONES

To make it easier to find out about what you are interested in at Open Day, we have zones set up on campus. Each zone focuses on a particular group of subjects and fields of study.

ARTS, LAW, SOCIAL SCIENCES & DESIGN

Location:

2.13

Subjects:

- Arts
- Communication Design
- Digital Learning
- Human Development
- Industrial Design
- Interface Design
- Law
- Māori and Indigenous Studies
- Media Design
- Pacific and Indigenous Studies
- Social Sciences:**
 - Environmental Planning
 - Geography
 - Philosophy
 - Political Science
 - Sociology
 - Social Policy
- Te Reo Māori

BUSINESS & MANAGEMENT

Location:

2.02

Subjects:

- Accounting
- Finance
- Marketing
- Strategic Management
- Supply Chain Management

EDUCATION

Location:

Level 1, The Hub

Subjects:

- Education & Society
- Teacher Education: Early Childhood, Primary and Secondary

HEALTH & SPORT

Location:

Ground Floor

Subjects:

- Health
- Medicine
- Midwifery
- Nursing
- Pharmacy
- Sport and Human Performance

STEM & NATURAL ENVIRONMENT

Location:

1.07, Te Manawaroa

Subjects:

- Computer Science
- Crime Science
- Data Analytics
- Engineering
- Environmental Sciences
- Forensic Psychology
- Marine Science
- Mathematics
- Psychology

STUDENT ADVICE & SUPPORT

Location:

Level 1, The Hub

Services:

- Accessibility Services
- Accommodation
- Faculty of Māori and Indigenous Studies
- Māori ki Waikato and Te Toka a Tirikawa
- Pacific at Waikato
- Programme Advice & Student Support
- Scholarships
- Sir Edmund Hillary & Student-Athlete Support Hub (SASH)
- Work-Integrated Learning